

RUBINETTO A MASCHIO A DUE VIE  
TWO-WAYS PLUG-COCK

**DECRETO LEGISLATIVO 25/02/2000 N° 93**  
il prodotto illustrato nella presente scheda tecnica soddisfa i requisiti della direttiva PED 97/23/CE ed e' esentato dalla marcatura CE in base all'art.3 par. 3.

**DECREE LAW DD. 25/02/2000 NO.93**  
the product showed in this technical sheet is made according to PED 97/23/CE and it is CE marking-free as per art. 3 par.3.

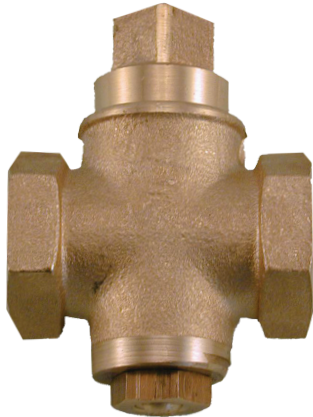

**500**

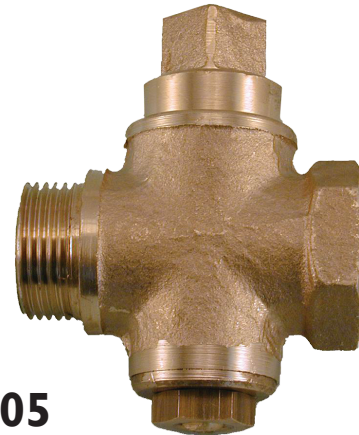

**505**

CARATTERISTICHE

FEATURES

Corpo e maschio in ottone "DELTA CS" CB 753S UNI-EN 1982

Brass "DELTA CS" CB 753S UNI-EN 1982 body and plug

Filettatura EN-ISO 228/1

Threading to EN-ISO 228/1

Finitura sabbiata

Sand blast finishing

DIMENSIONI PRINCIPALI

LEADING DIMENSIONS

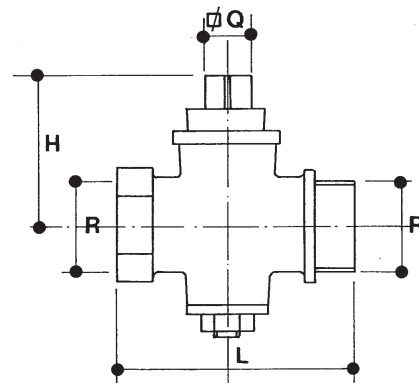
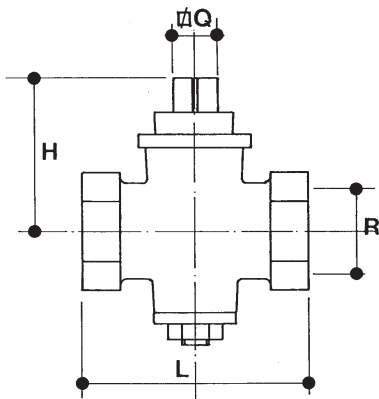

R"	3/8	1/2	3/4	1	1 1/4	1 1/2	2
L	40	49	56	69	76	87	98
H	30	36	47	56	60	70	80
Q	11	12	14	16	19	20	25

R"	3/8	1/2	3/4	1	1 1/4	1 1/2	2
L	48	53	63	68	89	100	109
H	31	32	46	50	60	70	80
Q	10	12	14	17	19	20	25

PRESSIONI DI ESERCIZIO A MAX 80°C

WORKING PRESSURES AT 80°C MAX

R"	1/4	3/8	1/2	3/4	1	1 1/4	1 1/2	2
PN 10								
PN 6								

CAMPO DI IMPIEGO (PED 97/23/CE ART.9)

FIELD OF USE

Alle pressioni e temperatura indicate nella precedente tabella le valvole sono utilizzabili per i seguenti fluidi:

Liquidi non pericolosi (Tab. 9);

Quanto sopra dichiarato è valido a condizione che i fluidi non siano aggressivi per le leghe di rame (bronzo-ottone).

At the pressures and temperature stated in previous table, the valves can be used for the following fluids:

Non-dangerous liquids (Tab.9) ;

The above statement is valid if the fluids concerned are non-aggressive to the copper alloys (bronze-brass).